

1 Detail: Cabin Soffit
SCALE: 3" = 1'-0"

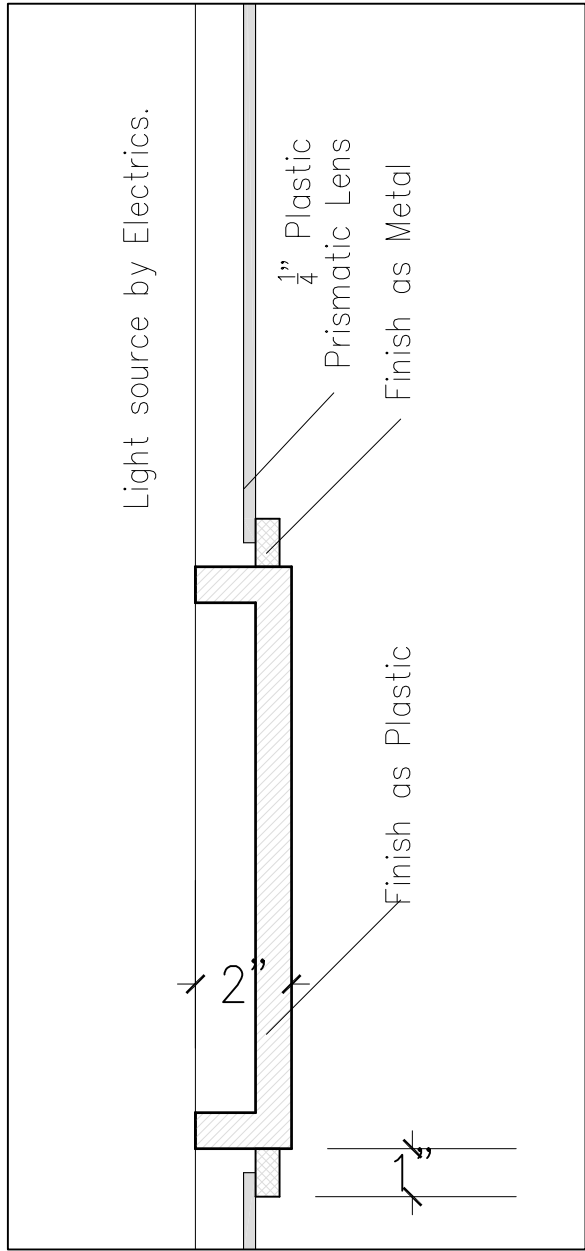

2 Detail: Galley Ceiling
SCALE: 3" = 1'-0"

2 Reflected Ceiling Plan: Airplane
SCALE: 1/4" = 1'-0"

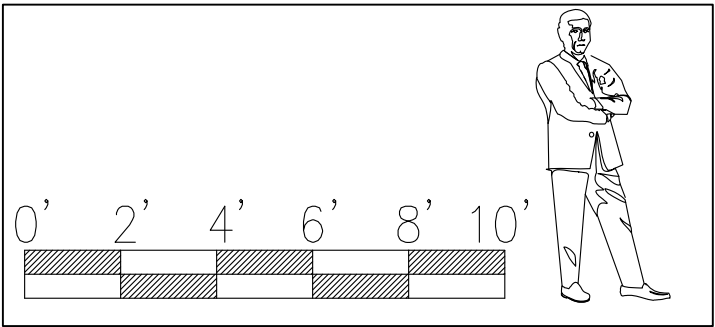

LIFE ON MARS			Episode: 114	
Director: David Petrarca		Production Designer: Stephen Hendrickson		
		Art Director: Ford/Keister		
Scale: As Noted	Date: 1/21/09	Drawn By: AF	Set No: Sheet/	
Description: Reflected Ceiling Plan			nh	
Location: Studio H		Shoot Date:		
Address: Kaufman Astoria Studios		T 2/3		3/8

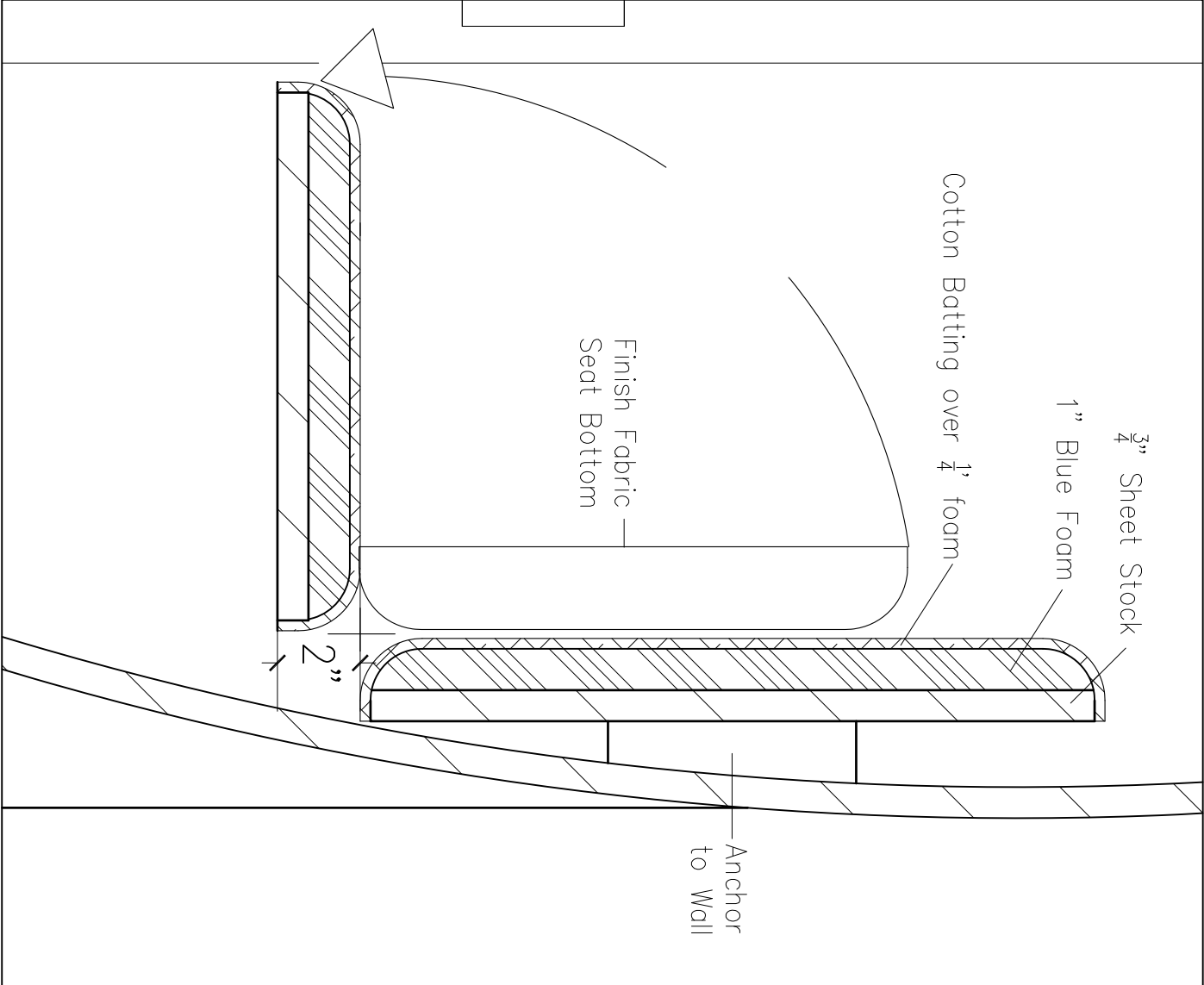
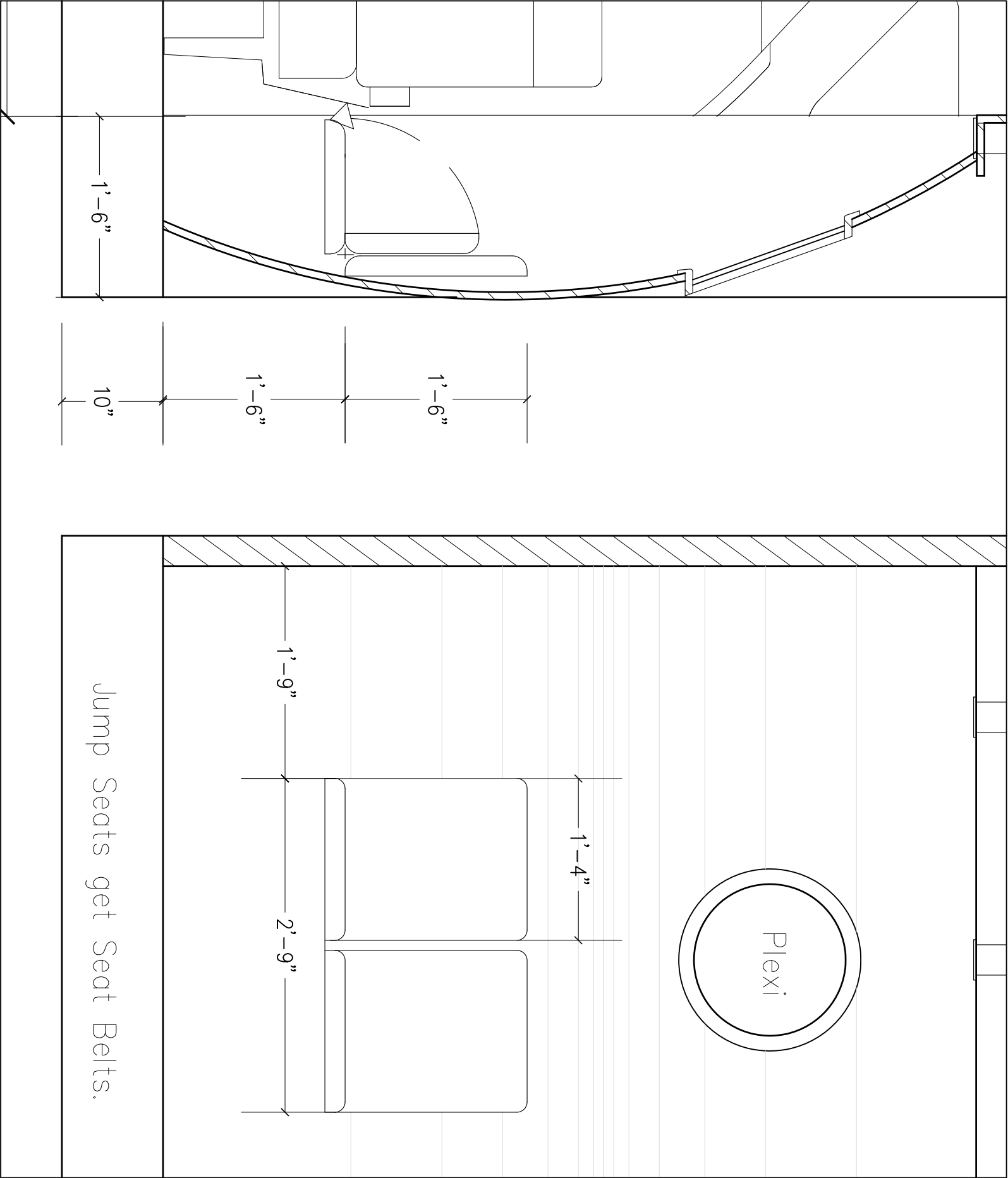

1 Jump Seats: Airplane
SCALE: 1" = 1'-0"

1 Jump Seats: Section
SCALE: 3" = 1'-0"

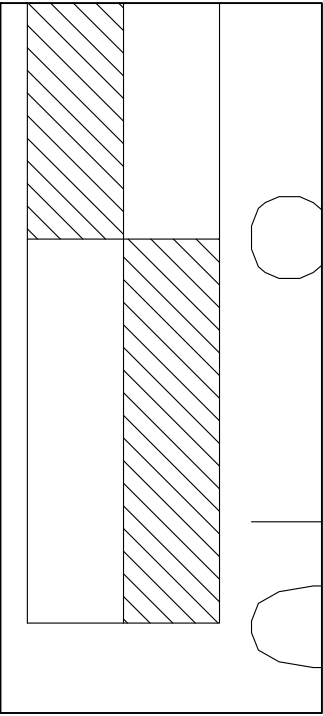

Episode:			114		
Director:			David Petrarca		
Production Designer:			Stephen Hendrickson		
Art Director:			Ford/Keister		
Scale:	Date:	1/21/09		Drawn By:	AF
As Noted	Revision:				
Description:	Jump Seats				nh
Location:	Studio H	Shoot Date:	t 2/3		4/8
Address: Kaufman Astoria Studios					

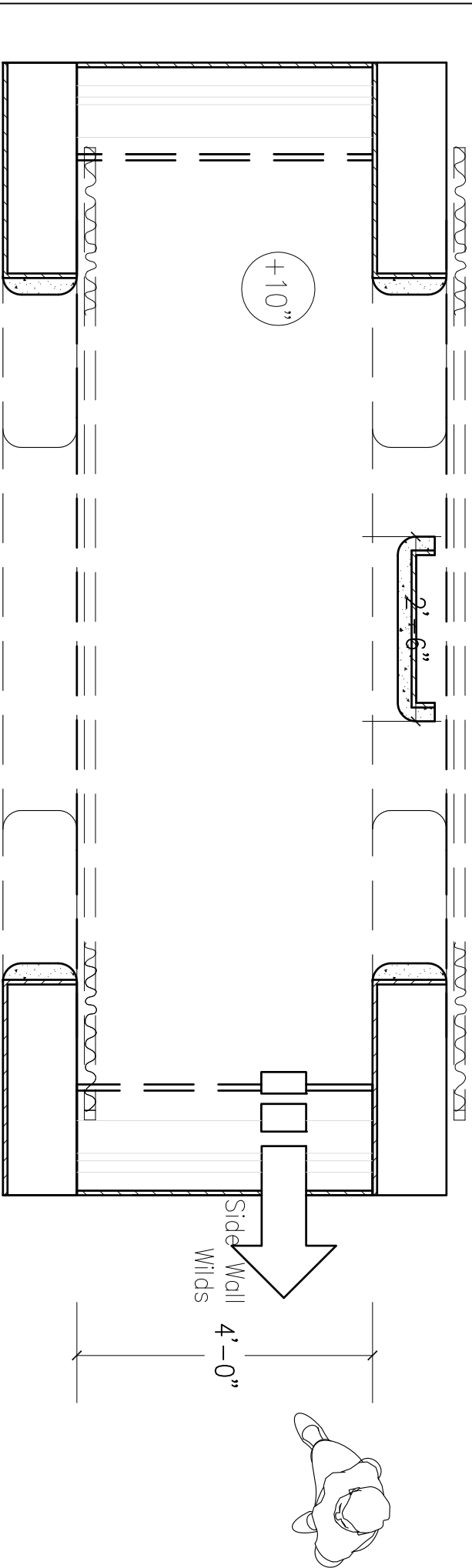
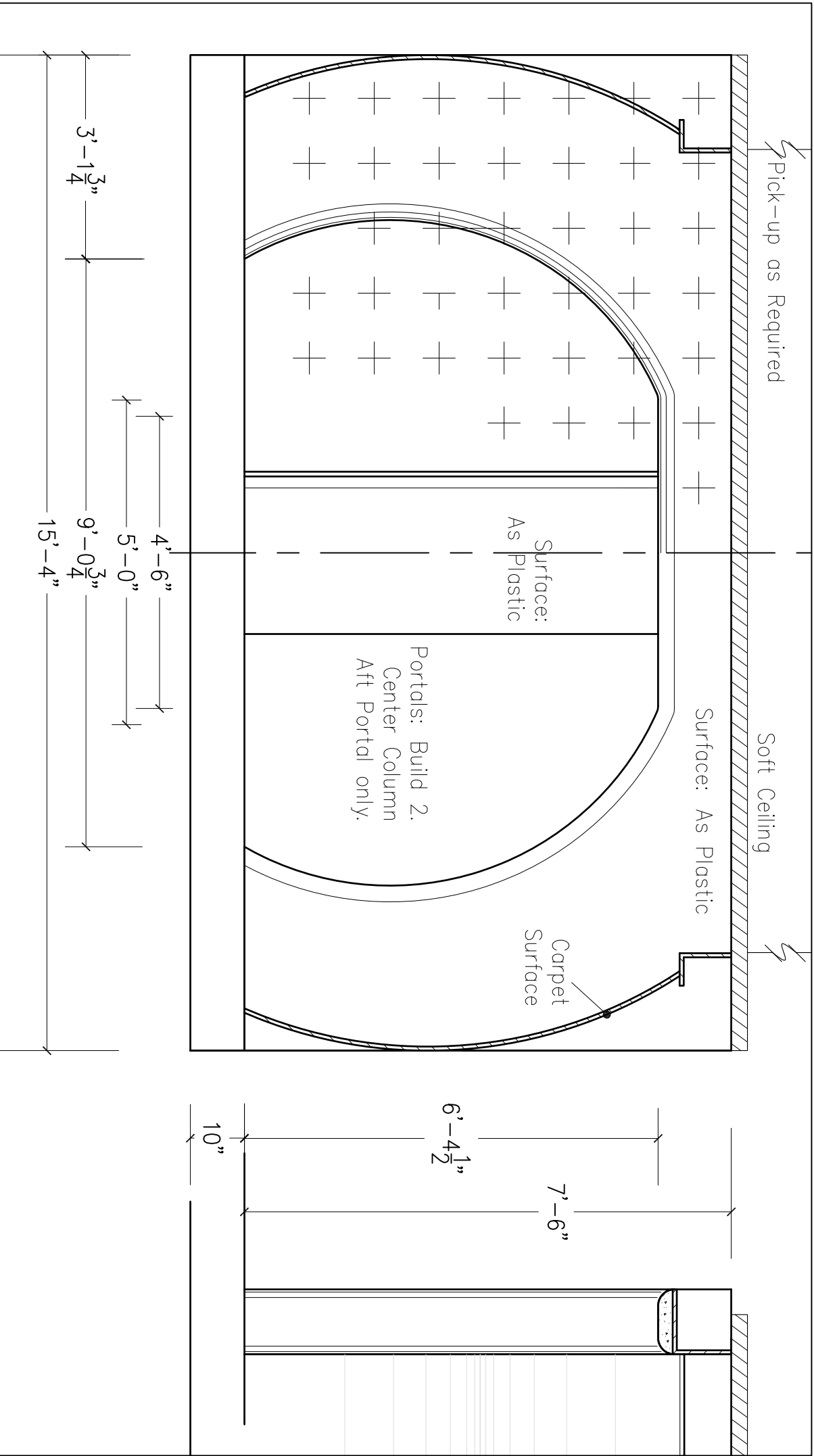

5A Rear Portals & Walls: Airplane
SCALE: 1/2" = 1'-0"

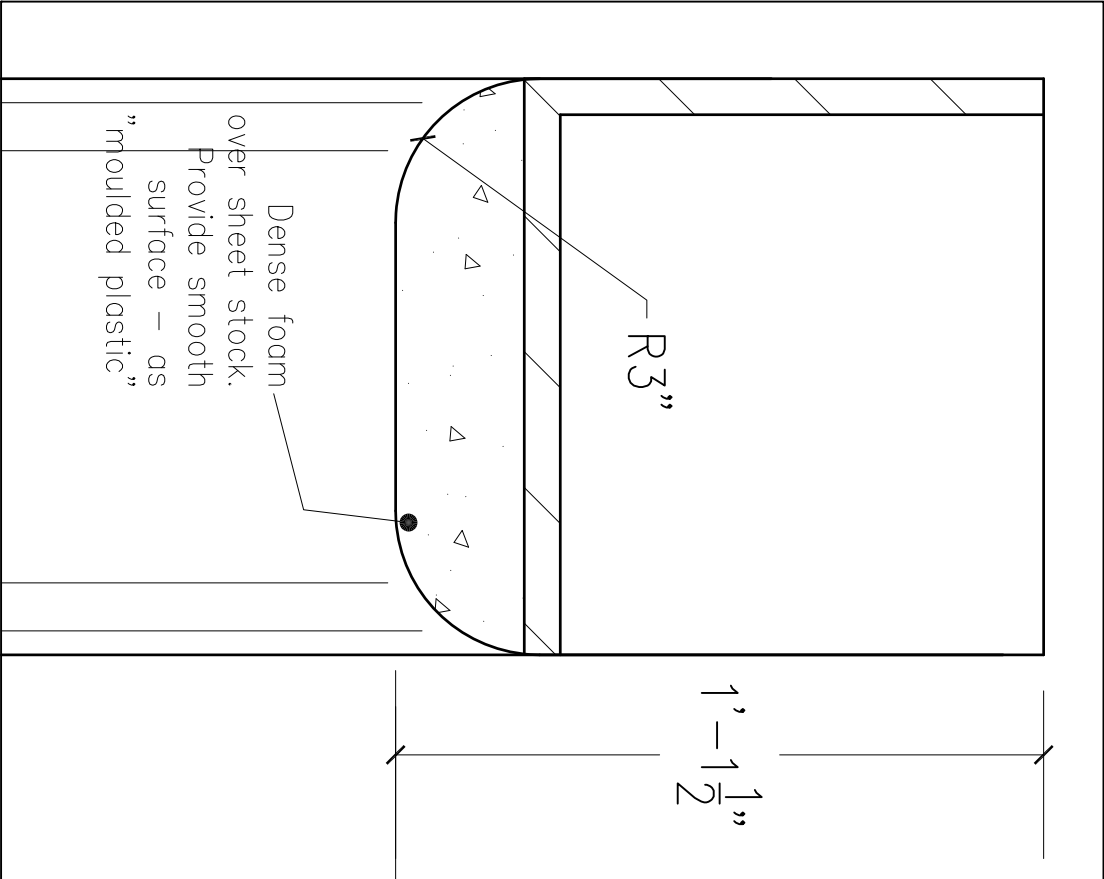

1 Detail: Mars Soffit
SCALE: 3" = 1'-0"

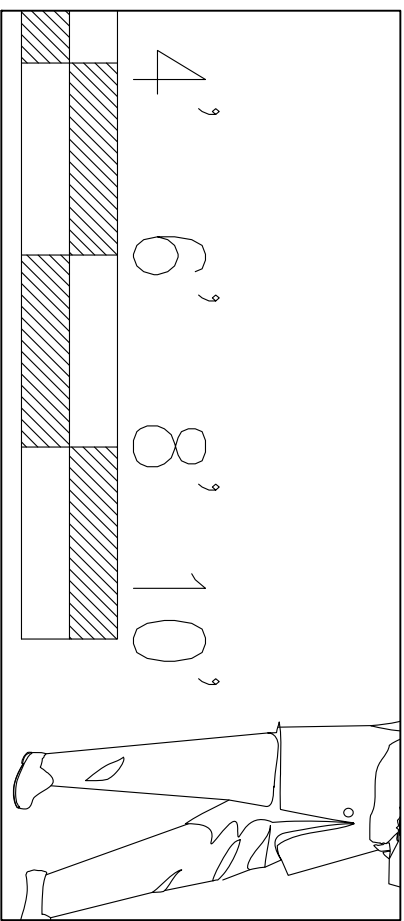

WIFERS				Episode: 114
Director:	David Petrarca	Production Designer:	Stephen Hendrickson	
Scale:	As Noted	Date:	1/21/09	
As Noted	Revision:	Drawn By:	AF	
Description:	Rear Portals			
Location:	Studio H	Shoot Date:	W 2/4	nh
Address:	Kaufman Astoria Studios			5/8

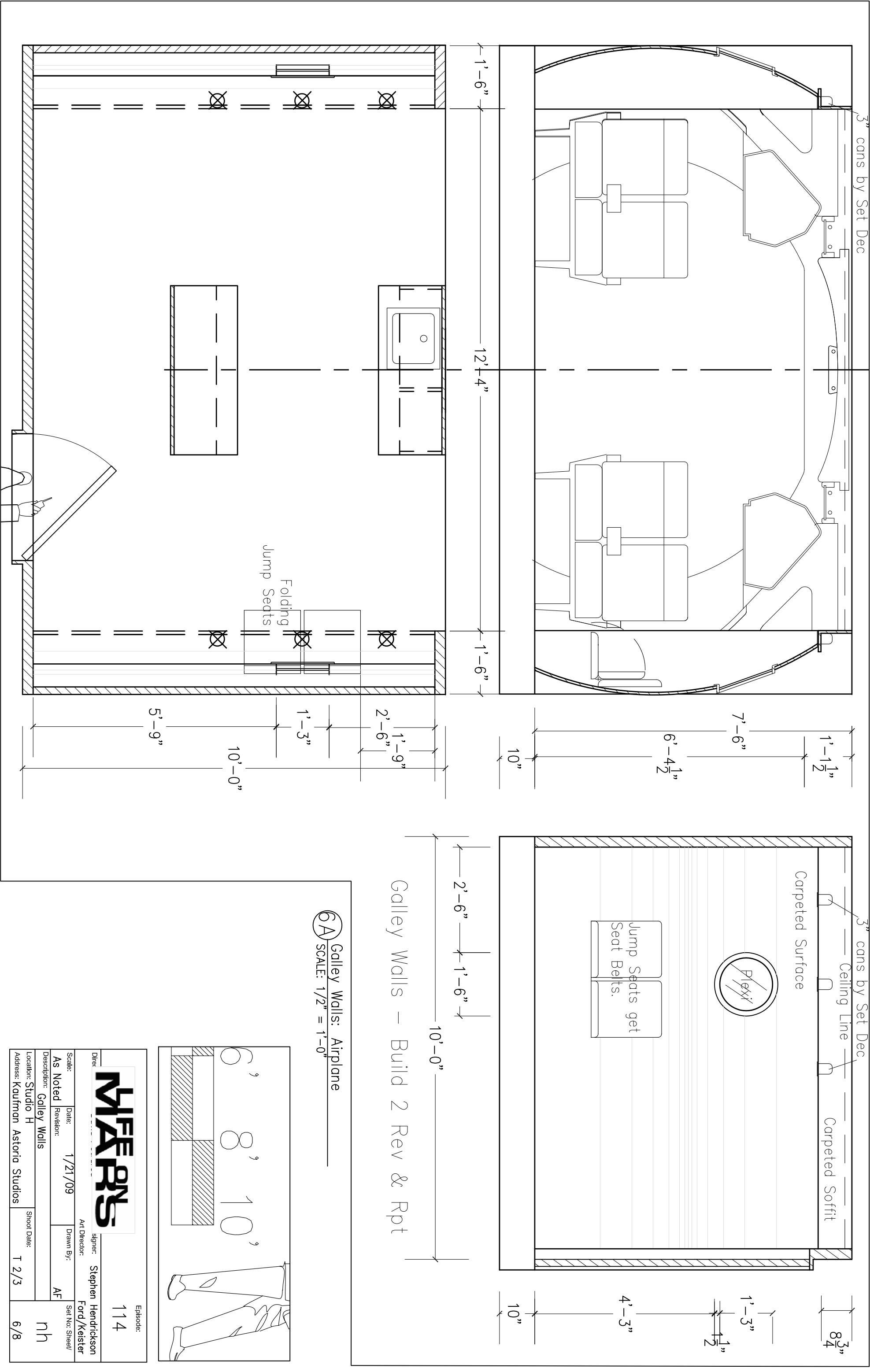

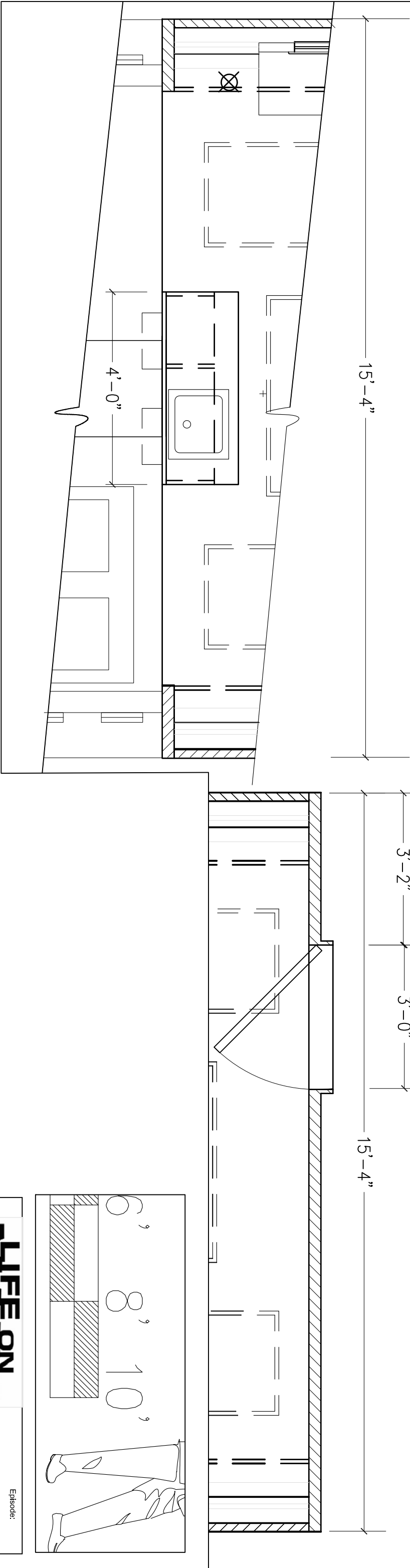
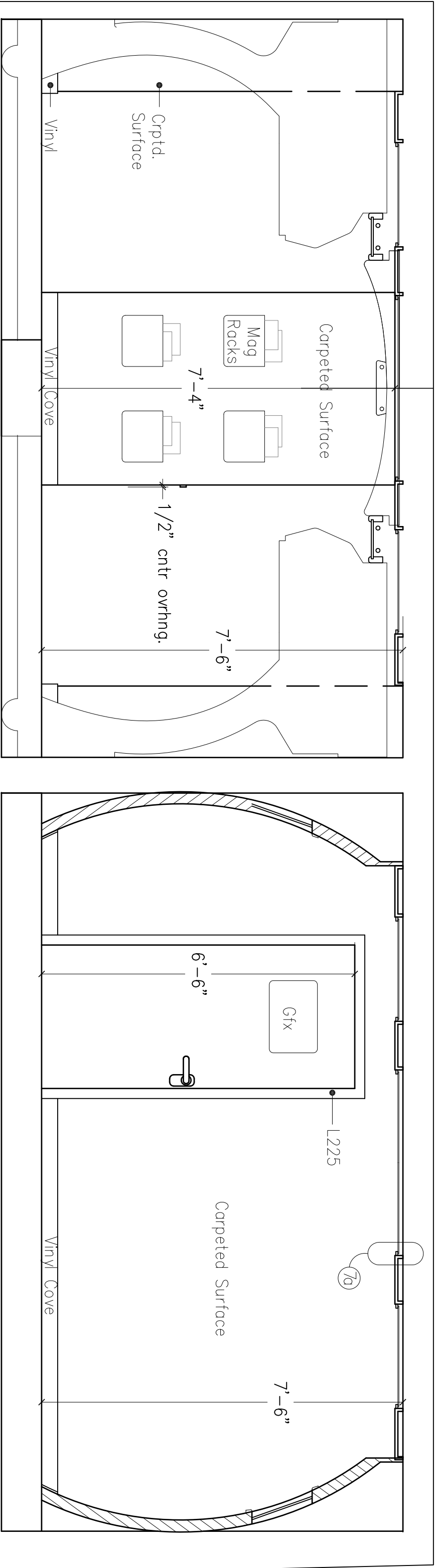

1 Galley Walls Fore and Aft: Airplane
SCALE: 1/2" = 1'-0"

WIFE WARS				Episode: 114	
Director:	David Petrarca		Production Designer:	Stephen Hendrickson	
Art Director:			Ford/Keister		
Scale:	Date:	1/21/09		Drawn By:	AF
As Noted	Revision:				
Description:	Galley Walls				nh
Location:	Studio H		Shoot Date:	T 2/3	
Address: Kaufman Astoria Studios			7/8		

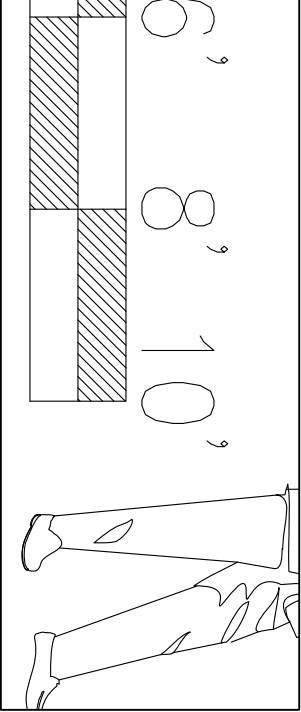

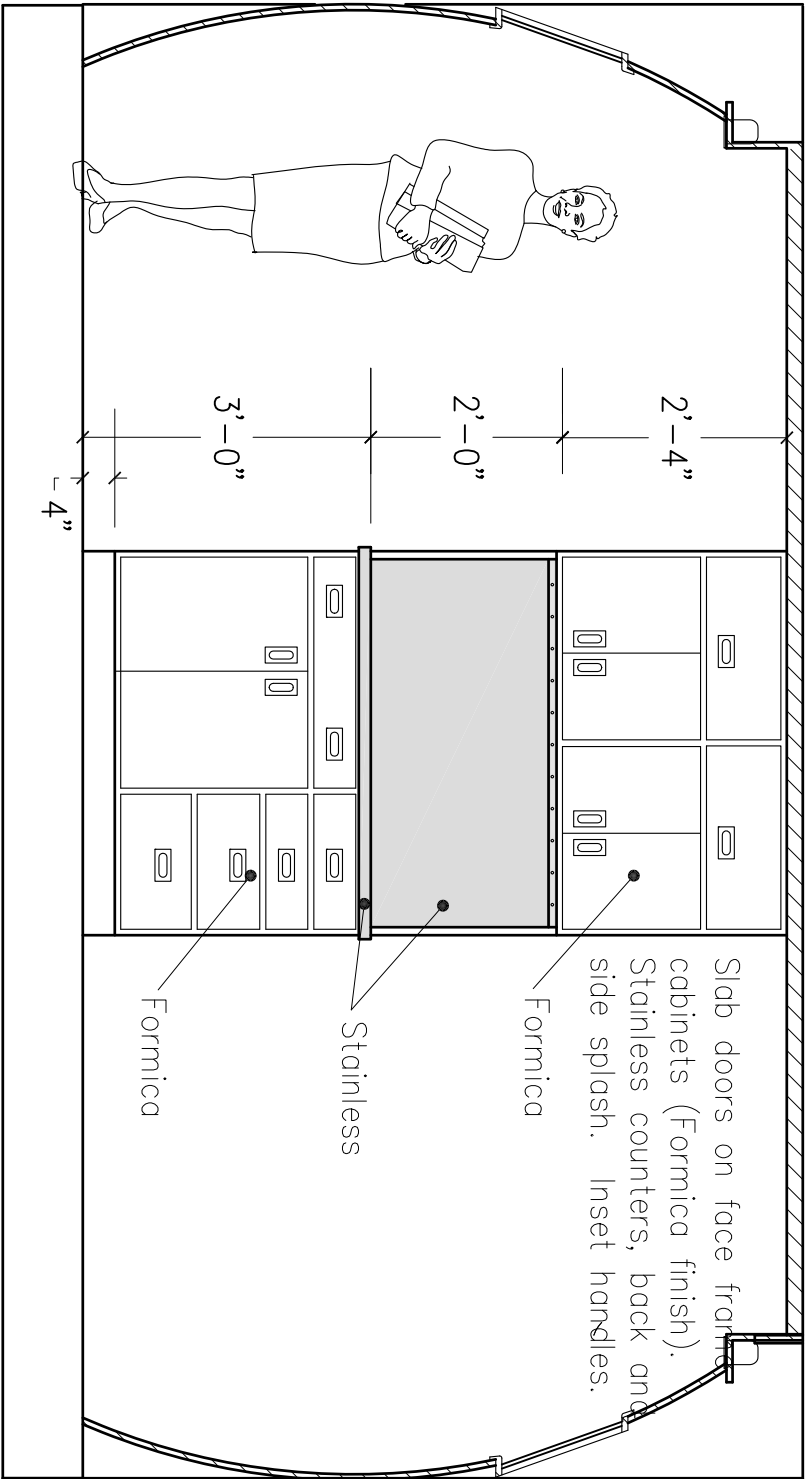

8A Galley Cabinets Aft: Airplane
SCALE: 1/2" = 1'-0"

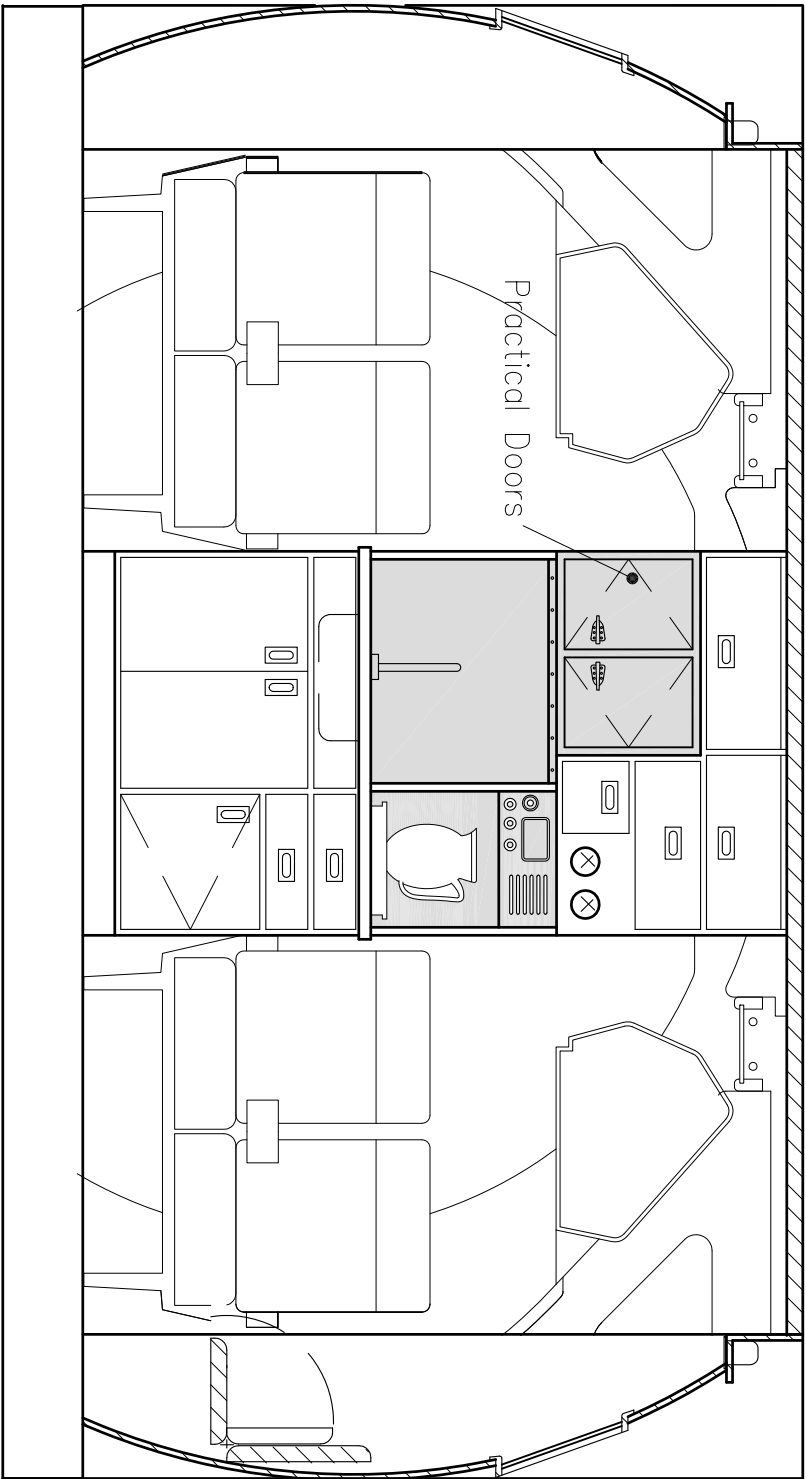

8B Galley Cabinets Forward: Airplane
SCALE: 1/2" = 1'-0"

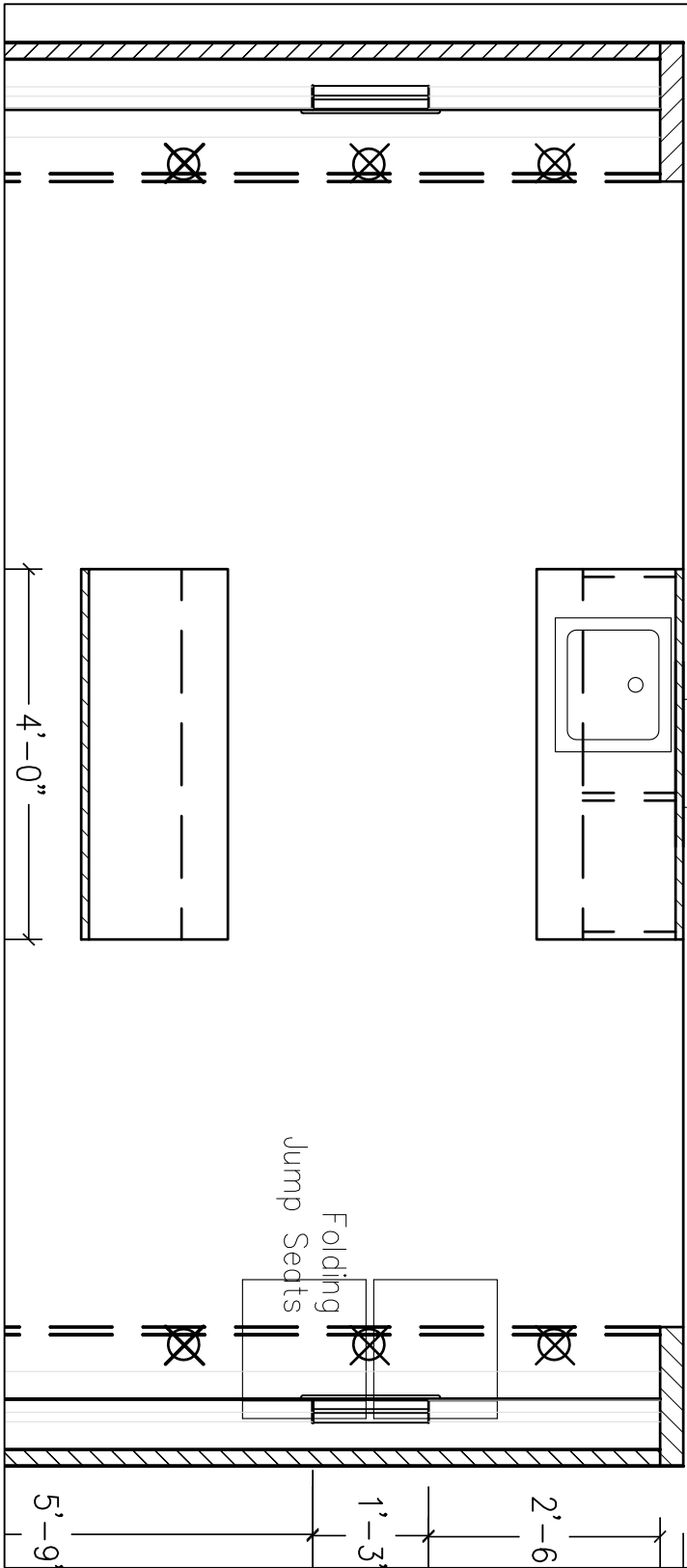

1 Galley Cabinets: Airplane
SCALE: 1/2" = 1'-0"

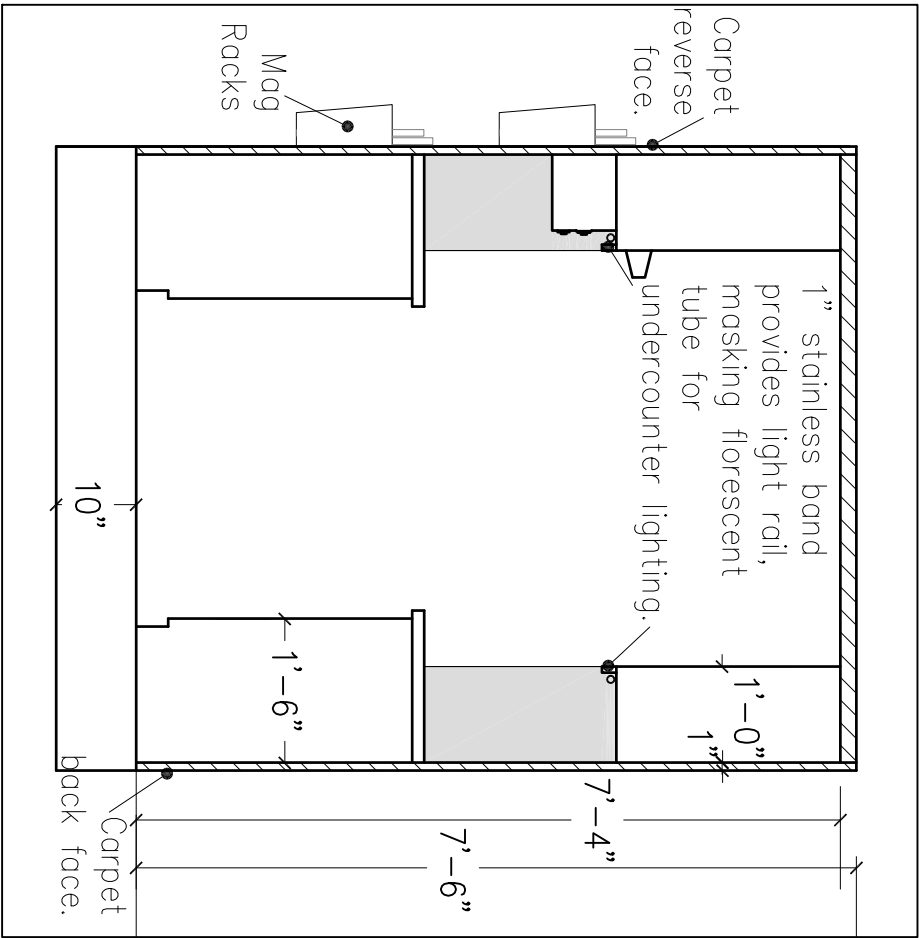

1 Profile Galley Cabinets
SCALE: 1/2" = 1'-0"

W&P'S				Eskotic	
114				114	
Director: David Petrarco				Production Designer: Stephen Hendrickson	
Art Director: Stephen Hendrickson				Ford/Keister	
Scale: As Noted				Set No: Steel	
Date: 1/21/09				AF	
Revised: AF				nh	
Description: Galley Cabinets				8/8	
Location: Studio H				Shoot Date: T 2/3	
Address: Kaufman Astoria Studios				T 2/3	